



298 Geoffrey Road CHITTAWAY POINT NSW

5 🏠 3 🚗 6 🚗

Set upon a 967m2 block on the prestigious peninsula of Chittaway Point this stunning deep waterfront home offers a rare opportunity to secure your own piece of exclusive Central Coast paradise.

This master built family home offers a spacious open floorplan designed to maximise your enjoyment and capture the magic of the luxurious waterfront lifestyle.

Divided into two sections separated by a stunning in-ground pool, the main house opens onto a waterside alfresco entertaining deck and features 4 generous bedrooms all opening onto balconies with an ensuite and walk in robe to the main.

Downstairs the open plan living area enjoys water views and is complimented by a stylish gourmet kitchen. A 2nd

Price : \$ 1,415,000
Land Size : 967 sqm
View : <https://www.coastwidefn.com.au/sale/nsw/central-coast-region/chittaway-point/residential/house/5623477>



Adrian Simpson
02 4353 1999



Michael Eslick
0402 810 831

<https://www.coastwidefn.com.au>

We sell, rent and manage Real Estate, Residential, Lifestyle and Commercial across the Central Coast



FIRST FLOOR

Scale in metres. Indicative only. Dimensions are approximate. All information contained herein is gathered from sources we believe to be reliable. However we cannot guarantee its accuracy and interested persons should rely on their own enquiries.



298 Geoffrey Road, Chittaway Point

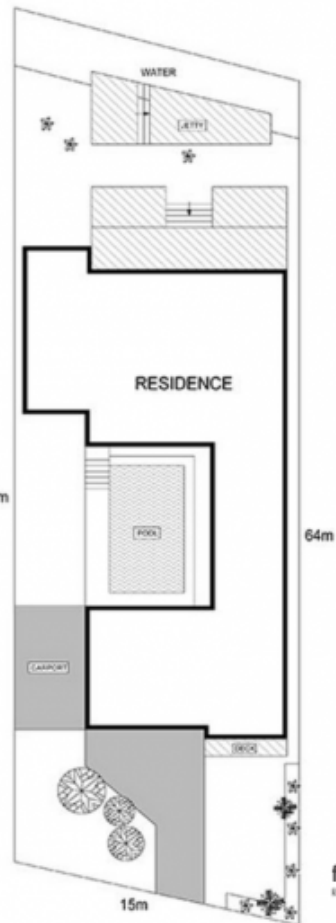

FIRST FLOOR

Scale in metres. Indicative only. Dimensions are approximate. All information contained herein is gathered from sources we believe to be reliable. However we cannot guarantee its accuracy and interested persons should rely on their own enquiries.



298 Geoffrey Road, Chittaway Point

