



### 17A Woodbury Park Drive Mardi NSW

3 1 1

This beautifully presented duplex underwent an internal refresh 3 years ago and is in fantastic condition.

Offering 3 bedrooms, all with built in robes, combined lounge and dining room, split system air conditioning, spacious kitchen with updated appliances, generous bathroom with separate shower and bath, a single lock up garage with internal entry and a spacious private back yard.

A home of this quality in this location will not last long! Inspections are a must.

**Price** : \$ 470,000  
**Land Size** : 300 sqm  
**View** : <https://www.coastwidefn.com.au/sale/nsw/central-coast-region/mardi/residential/semi-detached/5623982>



**David Manuelle**  
02 4353 1999

<https://www.coastwidefn.com.au>

We sell, rent and manage Real Estate, Residential, Lifestyle and Commercial across the Central Coast

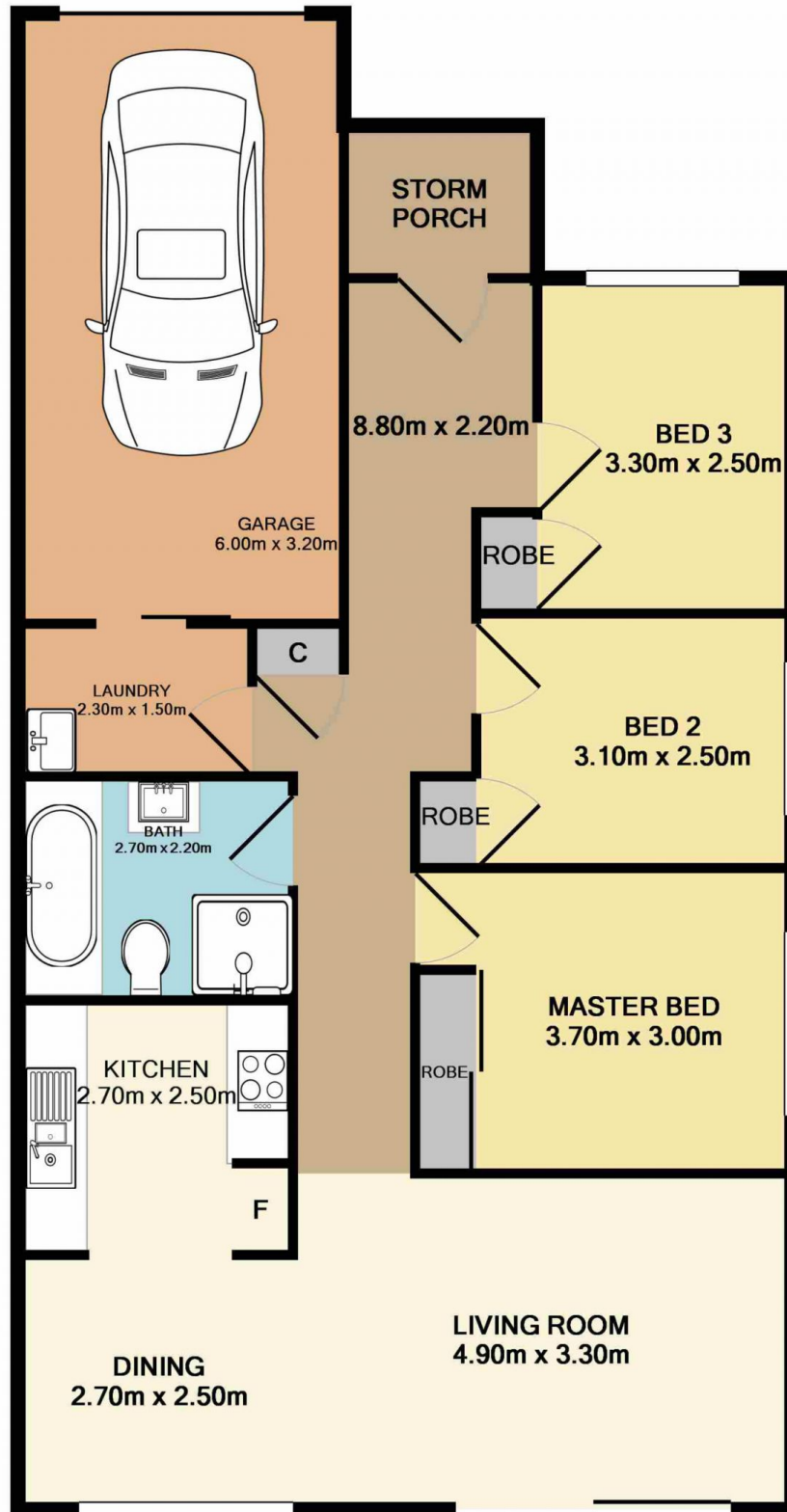

Total Approx. Floor Area 103.1 SQ.M. 1110 SQ.FT.

Measurements are approximate. Not to scale. For illustrative purposes only. Boundaries are approximate.

## SITE PLAN

