



### 17A Woodbury Park Drive Mardi NSW

3  1  1 

This impressive duplex has been listed and sold prior to going to market. The home offers a comfortable floor plan, an excellent location and a great opportunity for the home buyer or investor.

This is a prime opportunity to purchase a fantastic property in a sought after location within walking distance to schools, Westfield Shopping Centre, Tuggerah Station and within close proximity to the M1 Motorway access.

**Price** : \$ 487,500  
**Land Size** : 300 sqm  
**View** : <https://www.coastwidefn.com.au/sale/nsw/central-coast-region/mardi/residential/semi-detached/5624149>



**Adrian Simpson**  
02 4353 1999

<https://www.coastwidefn.com.au>

We sell, rent and manage Real Estate, Residential, Lifestyle and Commercial across the Central Coast

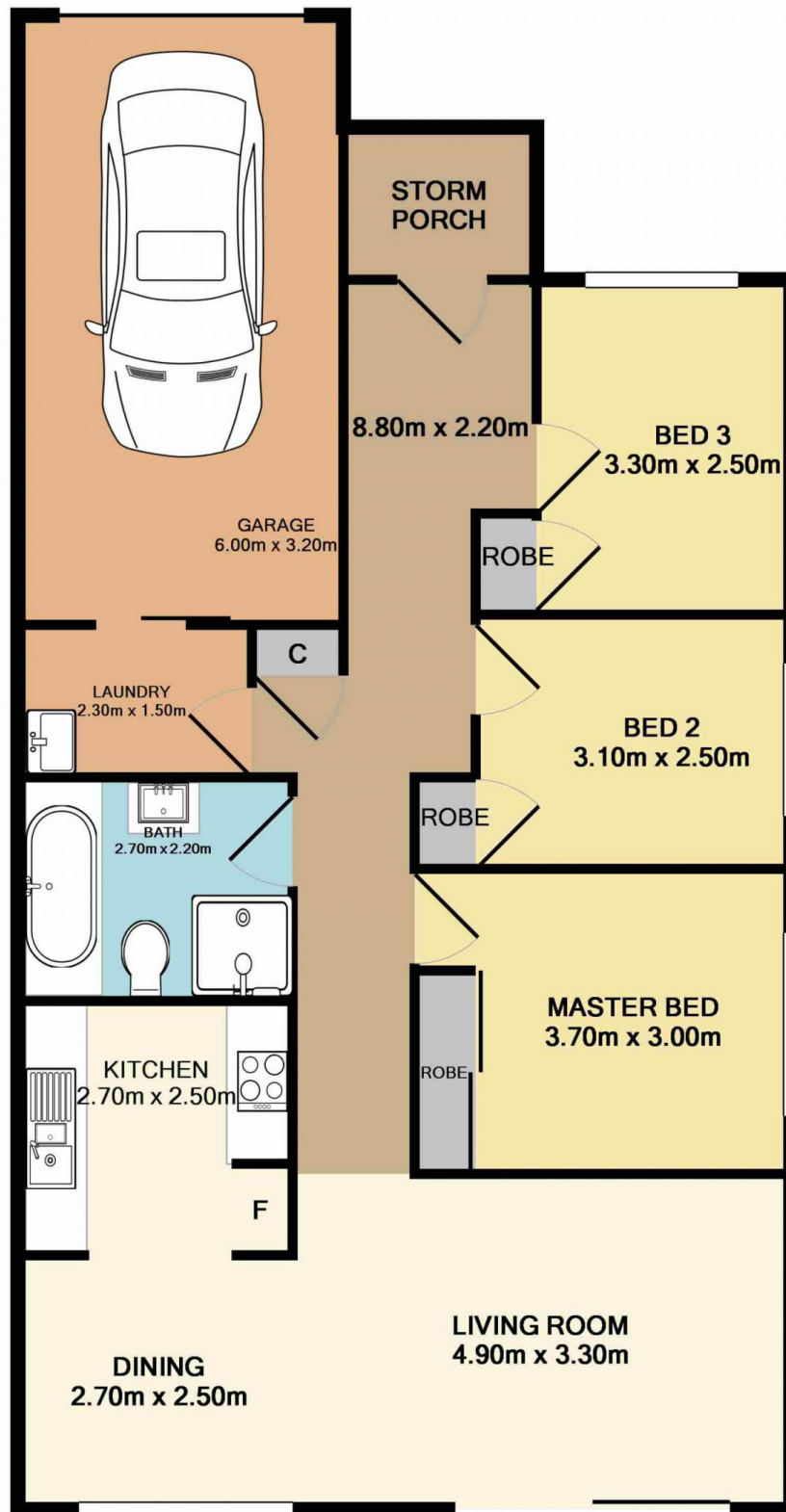

Total Approx. Floor Area 103.1 SQ.M. 1110 SQ.FT.

Measurements are approximate. Not to scale. For illustrative purposes only. Boundaries are approximate.

## SITE PLAN

