



23 Green Close Mardi NSW

3 2 1

Located within a short walk of Westfields shopping center & Tuggerah Station this ideally located home is ideal for first home buyers, down sizers and investors.

Situated on a level 416.6m² (approx) block, this charming brick and tile home offers a conventional floor plan which consist of a generous lounge room with split system air conditioning and a gas heating point, a dining room off the kitchen, 3 bedrooms with built in wardrobes, the master with an ensuite, main bathroom with separate toilet, an under cover entertaining area and single lock up garage with drive thru access.

Investors can expect a return in the vicinity of \$580 per week.

DISCLAIMER: This advertisement contains information

Price : \$ 813,000
Land Size : 416.6 sqm
View : <https://www.coastwidefn.com.au/sale/nsw/central-coast-region/mardi/residential/house/8022579>



David Manuelle
02 4353 1999



Adrian Simpson
02 4353 1999

<https://www.coastwidefn.com.au>

We sell, rent and manage Real Estate, Residential, Lifestyle and Commercial across the Central Coast

23 Green Close, Mardi

SITE PLAN



Total Approx Floor Area 118.69 sq.m

Measurements are approximate. Not to scale. For illustrative purposes only. Boundaries are approximate

23 Green Close, Mardi

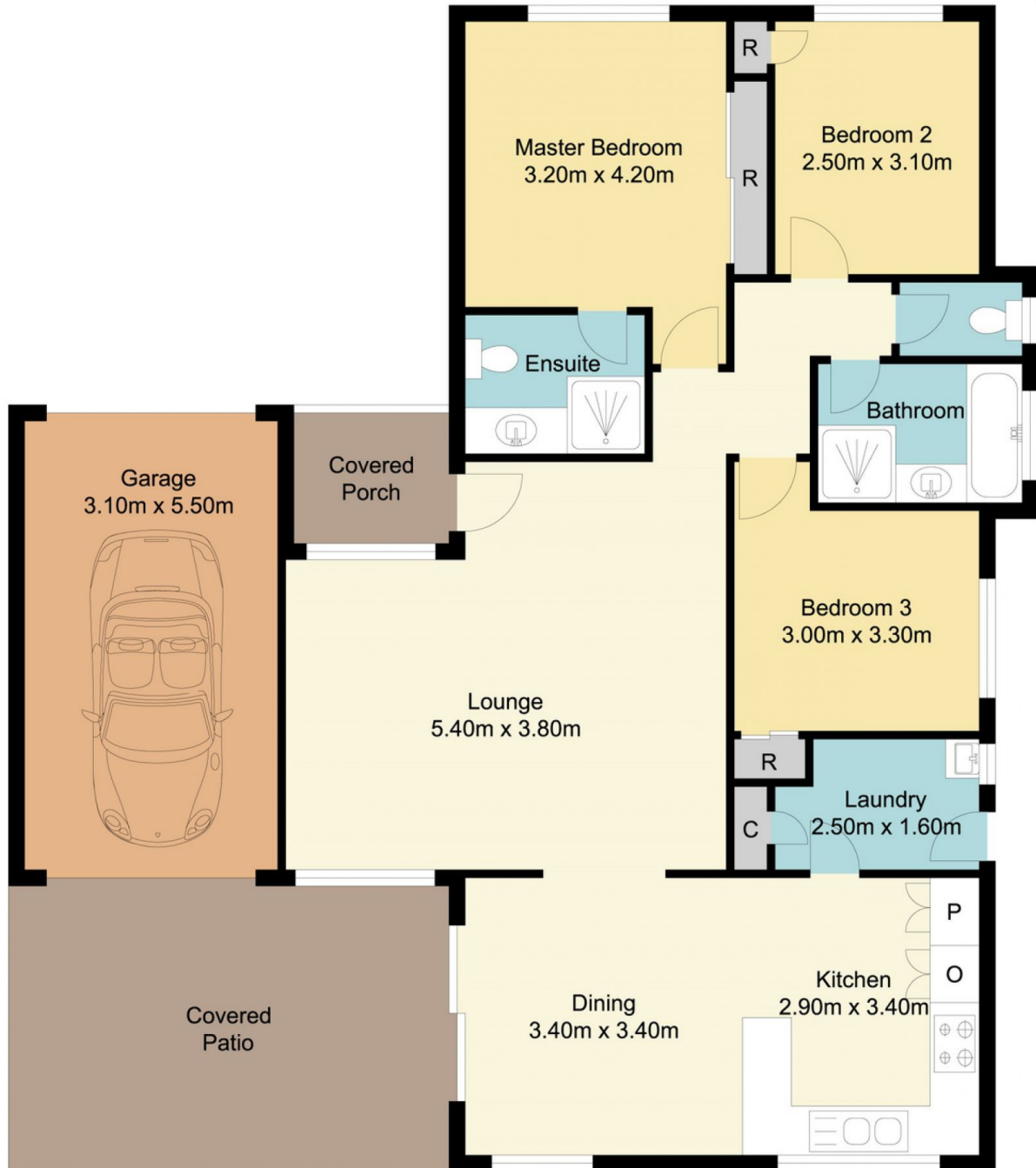
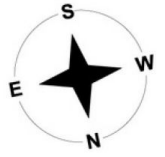

Total Approx Floor Area 118.69 sq.m

Measurements are approximate. Not to scale. For illustrative purposes only. Boundaries are approximate